

H1-1001 - H1-1002

NORTHSKY

24" & 30" OSCILLATING PEDESTAL FAN

SFSC-600.31.07 (H1-1001)
SFSC-750.31.23 (H1-1002)



READ & SAVE THESE INSTRUCTIONS

READ AND SAVE THESE INSTRUCTIONS

To prevent serious injury or property damage, read and understand owner's manual before operating.

SAFETY INFORMATION

Warning

1. Unplug the fan before moving it or performing maintenance. Do not touch the fan when your hands are wet.
2. Those who are not qualified electricians should not disassemble, repair or rebuild the fan.
3. Unplug the fan when it is not in use.
4. DO NOT unplug the fan by holding the cable cord. Unplug by holding the plug.
5. DO NOT use the fan when there is damage to the cable cord or plug.
6. DO NOT use the fan close to the fire.
7. DO NOT insert your hand or other objects into the guard or the movable parts.
8. WARNING: To reduce the risk of fire or electric shock, do not use this fan with any solid-state speed control device.
9. If the supply cord is damaged, it has to be replaced by the manufacturer, its service agent or similarly qualified persons in order to avoid hazard.
10. Electric shock hazard. Do not expose to water or rain.
11. WARNING: To Reduce The Risk Of Fire, Electric Shock Or Injury To Persons, Do Not Use Replacement Parts That Have Not Been Recommended By The Manufacturer (e.g. Parts Made At Home Using A 3D Printer).

CAUTION

1. Unplug the fan from the socket and clean it with a soft cloth.
2. DO NOT immerse the fan.
3. Fit the guard onto fan before starting up the fan.

ASSEMBLY INSTRUCTION

1. Remove four screws and the spring washers from base and keep them for next step. Assemble the lower pole to the based by tighten the four screws and the spring washers removed before.

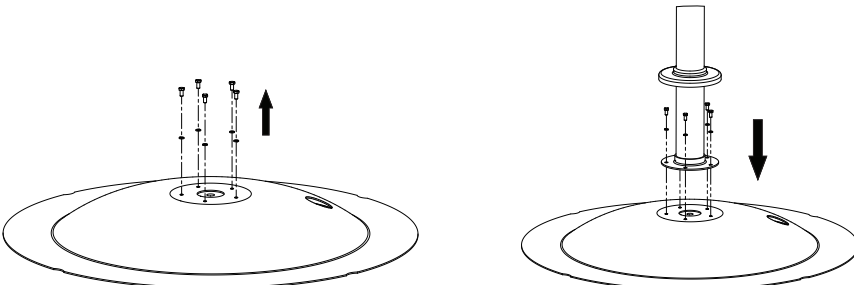

2. Insert the spring into the lower pole as shown in the picture below.

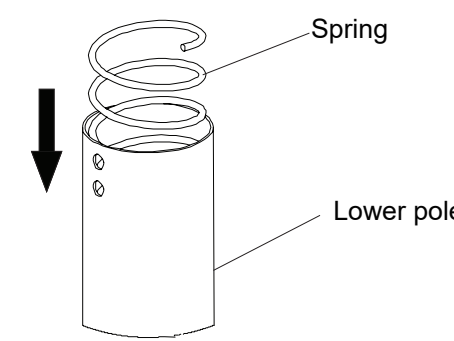

3. Remove the two screws from the upper pole and keep them for next step.

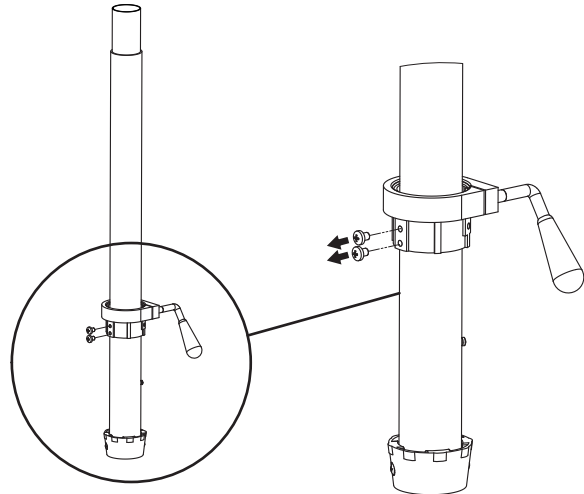

ASSEMBLY INSTRUCTION

4. Insert upper pole into lower pole and fix it by tightening the two screws from step 3. Adjust to the desired height and tighten it by locking the L-shaped handle.
NOTE: The upper pole will be springed upwards by the spring when trying to inserting the upper pole to the lower pole.

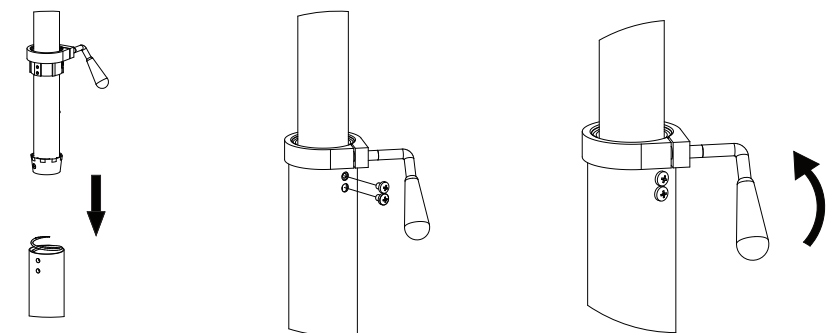

5. Attach the support frame to the upper pole and tighten it accordingly by using hex head screws and spring washers.

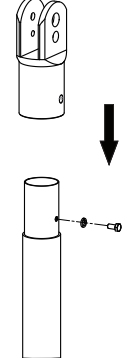

6. Secure the motor to the support frame and tighten it with the locking screws provided.

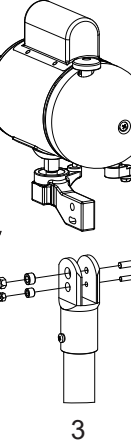

ASSEMBLY INSTRUCTION

7. Remove the external teeth lock washers, flat washers, spring washers and hex nuts from the motor and keep them for next step.

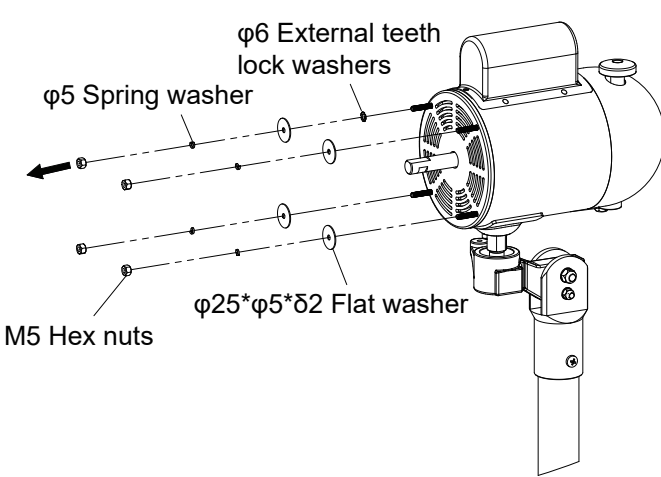

8. Secure the rear guard to the motor and fix it with the external teeth lock washers, flat washers, spring washers and hex nuts removed from step 7.

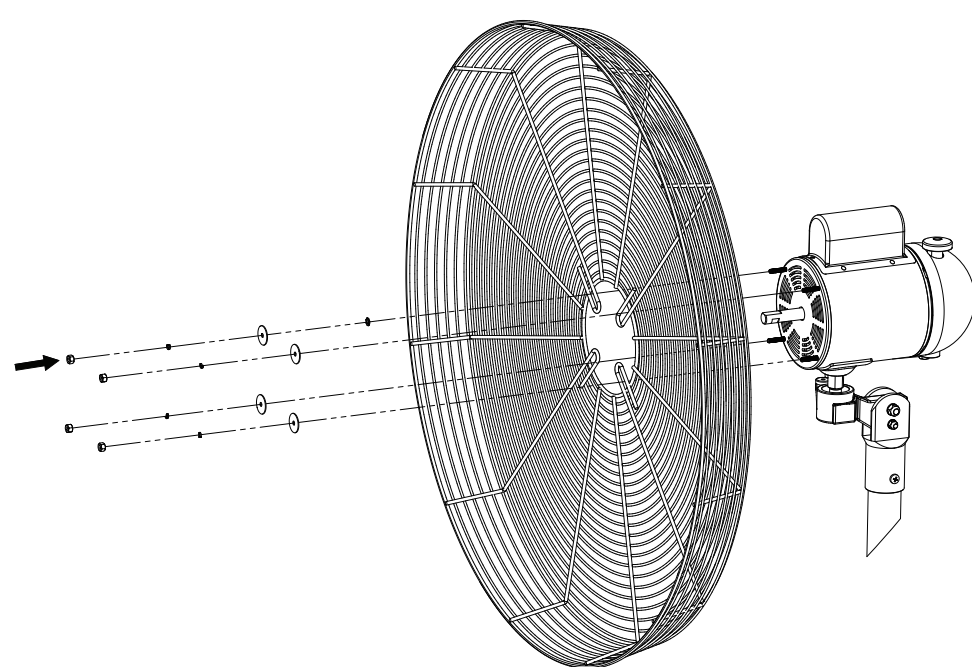

ASSEMBLY INSTRUCTION

9. Attach the fan blades to the motor shaft and lock it accordingly.

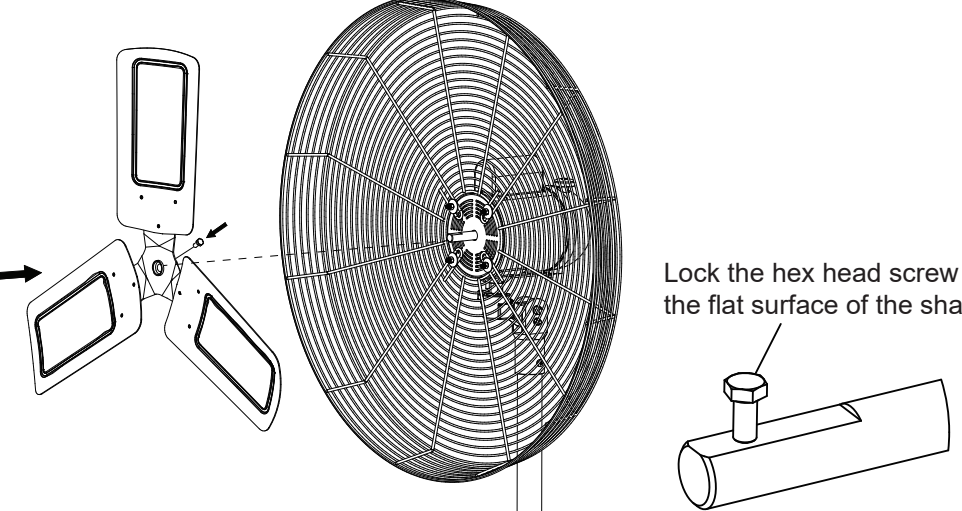

10. Position guard hooks of front guard into ribs of rear guard.

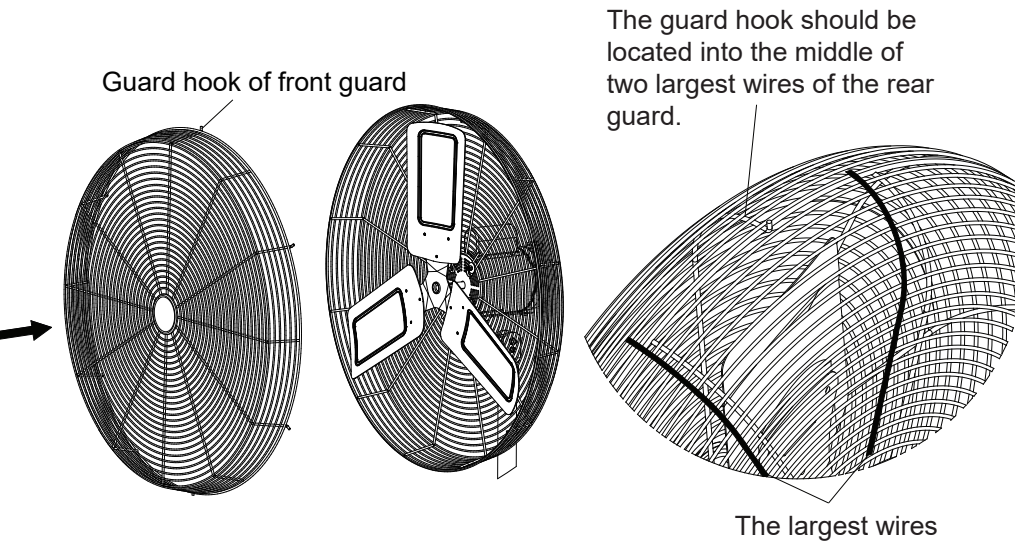

OPERATION INSTRUCTION

1. Use the pull chain switch located on back of motor to operate the fan or select speeds.

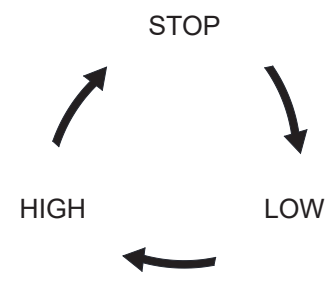

2. Turn the oscillation function on by pushing the oscillation button down. Turn the oscillation function off by pulling the oscillation button up.

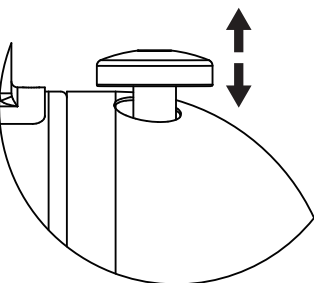

3. To adjust the angle of the fan head, loosen the M6 hex nut , tilt the fan head to the desired angle, and re-tighten the M6 hex nut.

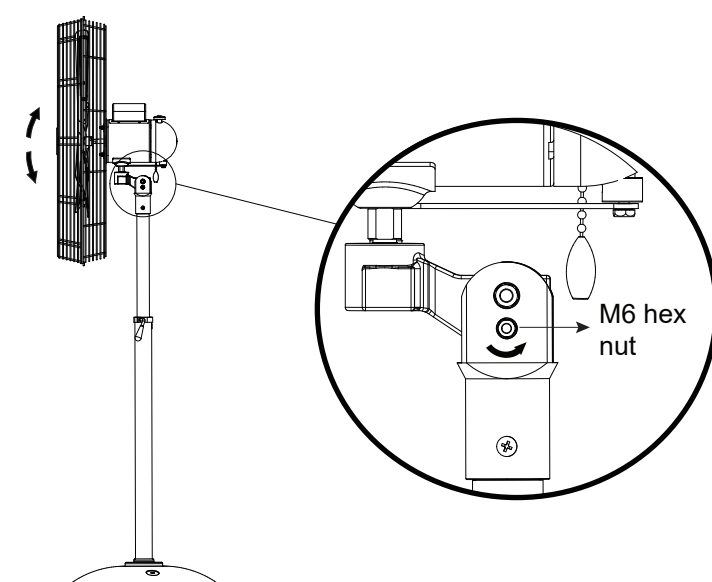

CARE AND CLEANING

Unplug the appliance before cleaning. Don't use any water for cleaning metal surfaces. Slightly moisten a cloth and then wipe off the surfaces of the fan. In order to remove dust from the grill, use a vacuum cleaner or remove the front grill by removing the securing screws on the edge of the grill. After cleaning, remount the grill. After doing this, fasten the screws on the edge of the grill.

1-YEAR LIMITED WARRANTY

The manufacturer warrants this product to be free from manufacturing defects in the material and workmanship under normal use for a period of one year after the date of purchase by the original purchaser. This warranty does not cover transit damages. This warranty does not apply to damages from accident, misuse, alteration of any kind to the fan or where the connected voltage is more than above the nameplate voltage. This warranty does not apply to the finish on any portion of the product. Servicing performed by unauthorized persons shall render the warranty invalid. The warranty is not responsible for damages of any kind, including accident and consequential damages. Some states do not allow the exclusion or limitation of the incidental or consequential damages, so the above exclusion or limitation may not apply to you. This warranty gives you specific legal rights, and you may also have other rights which vary from state to state.