

H1-1011 - H1-1012

NORTHSKY

24" & 30" OSCILLATING WALL MOUNT FAN

SFWC-600.53.07 (H1-1011)
SFWC-750.53.23 (H1-1012)

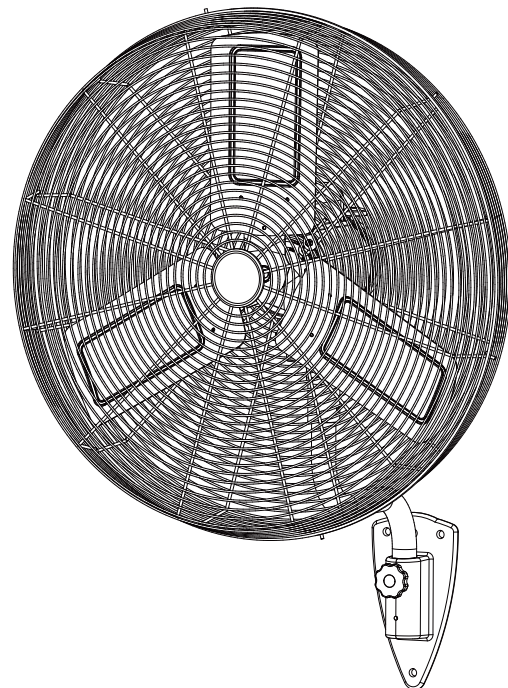

READ & SAVE THESE INSTRUCTIONS

READ AND SAVE THESE INSTRUCTIONS

To prevent serious injury or property damage, read and understand owner's manual before operating.

SAFETY INFORMATION

Warning

1. Unplug the fan before moving it or performing maintenance. Do not touch the fan when your hands are wet.
2. Those who are not qualified electricians should not disassemble, repair or rebuild the fan.
3. Unplug the fan when it is not in use.
4. DO NOT unplug the fan by holding the cable cord. Unplug by holding the plug.
5. DO NOT use the fan when there is damage to the cable cord or plug.
6. DO NOT use the fan close to the fire.
7. DO NOT insert your hand or other objects into the guard or the movable parts.
8. WARNING: To reduce the risk of fire or electric shock, do not use this fan with any solid-state speed control device.
9. If the supply cord is damaged, it has to be replaced by the manufacturer, its service agent or similarly qualified persons in order to avoid hazard.
10. Electric shock hazard. Do not expose to water or rain.
11. WARNING: To Reduce The Risk Of Fire, Electric Shock Or Injury To Persons, Do Not Use Replacement Parts That Have Not Been Recommended By The Manufacturer (e.g. Parts Made At Home Using A 3D Printer).

CAUTION

1. Unplug the fan from the socket and clean it with a soft cloth.
2. DO NOT immerse the fan in water or liquids.
3. Fit the guard onto fan before starting up the fan.

ASSEMBLY INSTRUCTION

1. Mark the hole locations by using the bracket, and then drill the holes.
2. For concrete wall installation, after drilling, you would insert the wall anchors and tap them flush with the wall, position the bracket and then screw the two bolts into the anchors, securely attaching the wall.
3. For wood wall installation, after drilling the smaller diameter pilot hole, position the bracket and screw the two bolts into the wall until they are secured.

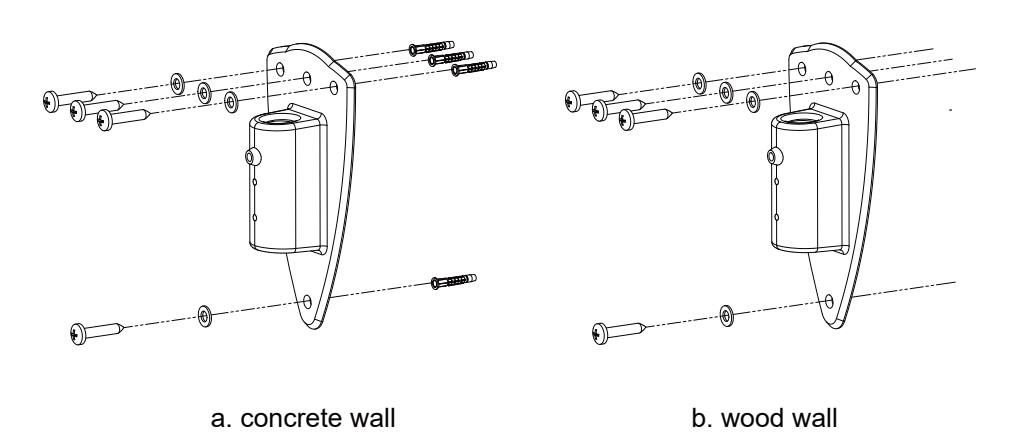

4. Remove the hex nuts, spring washers, flat washers and external teeth lock washers from the motor and keep them for next step.

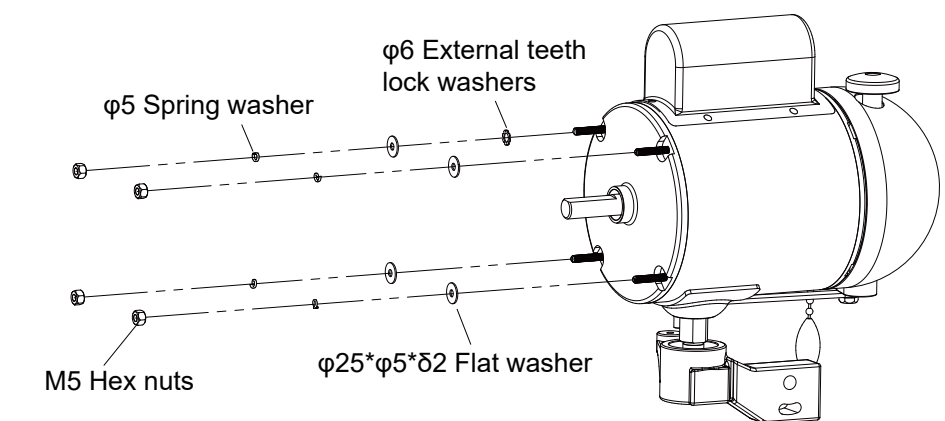

ASSEMBLY INSTRUCTION

5. Secure the rear guard to the motor and fix it with the external teeth lock washers, flat washers, spring washers and hex nuts removed from step 4.

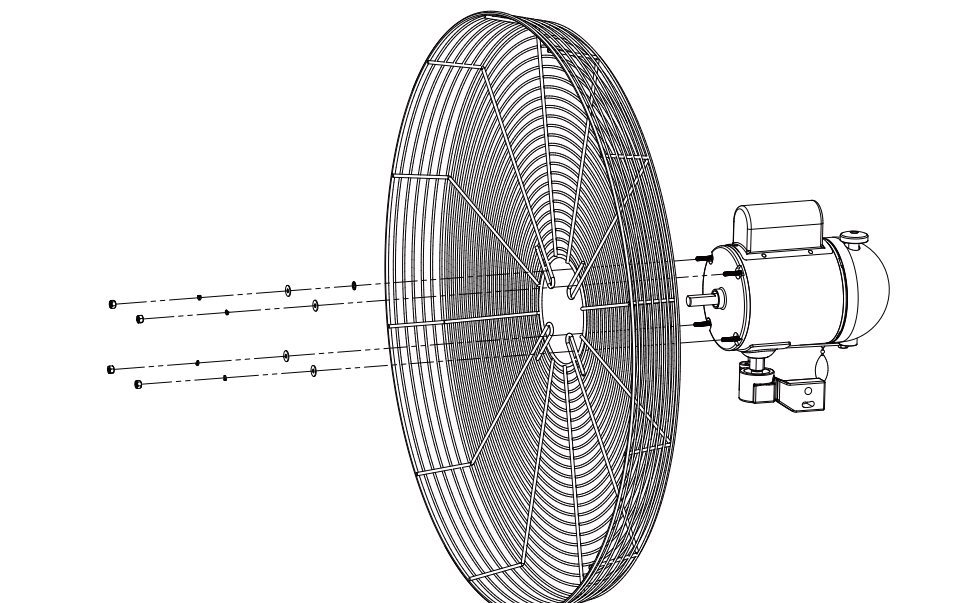

6. Attach the fan blades to the motor shaft and lock it accordingly.

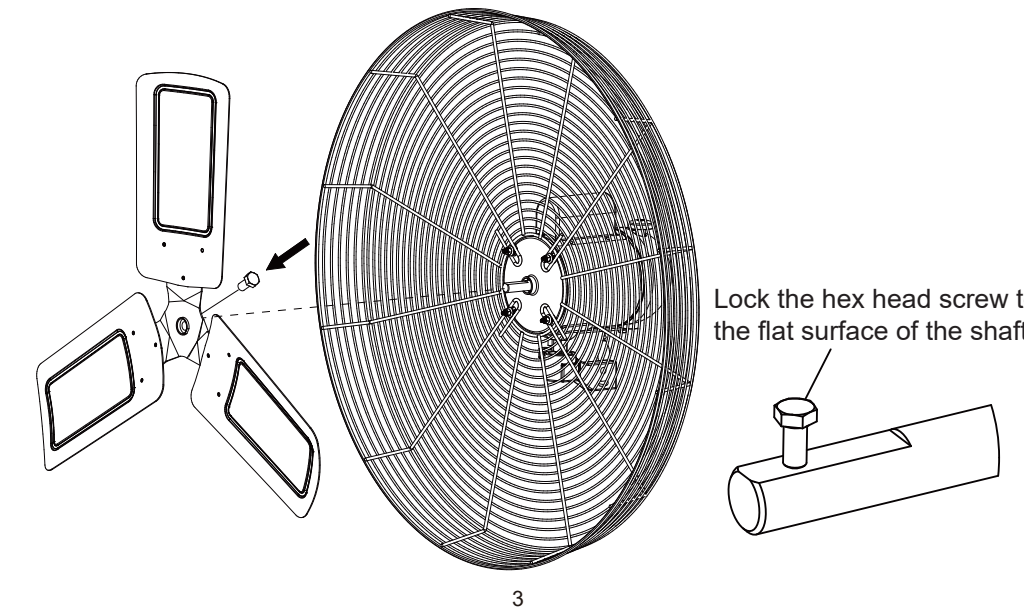

ASSEMBLY INSTRUCTION

7. Position guard hooks of front guard into ribs of rear guard.

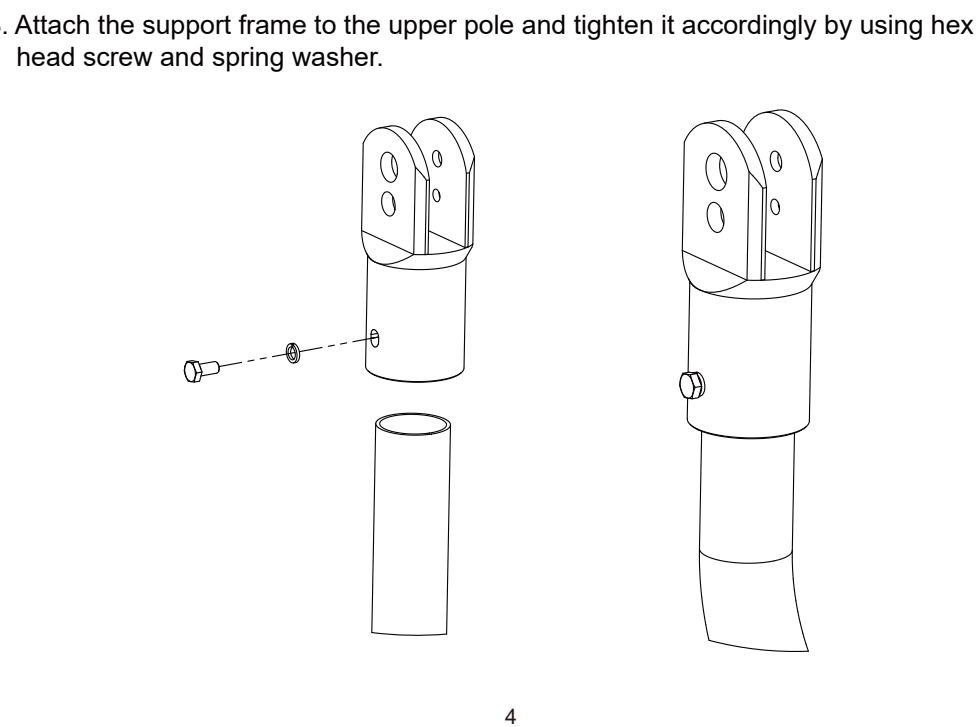
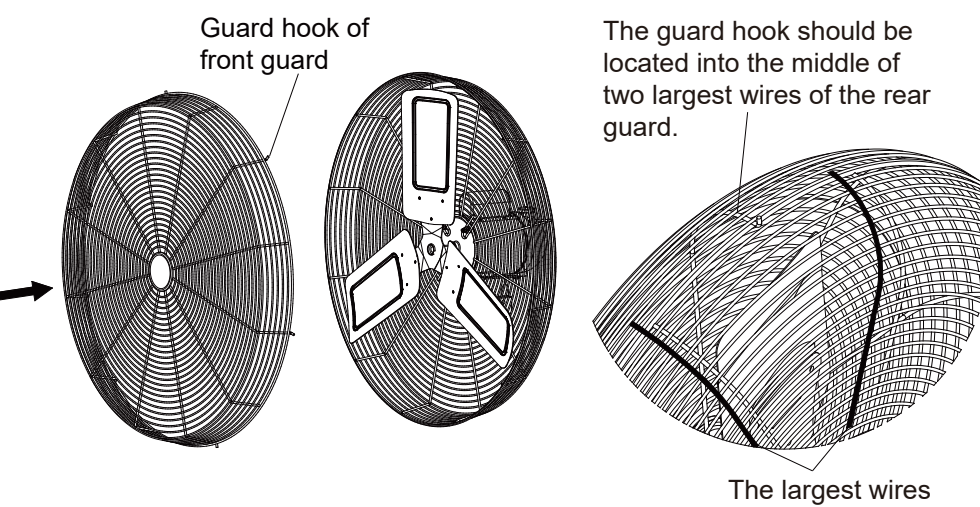

ASSEMBLY INSTRUCTION

9. Secure the motor to the support frame and tighten it with the locking screws provided.

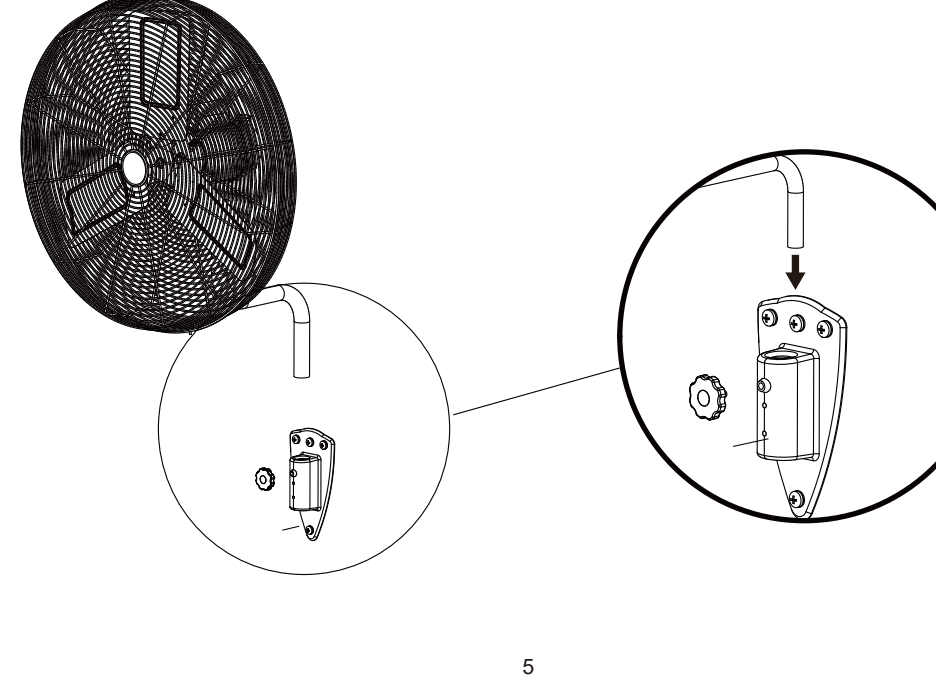
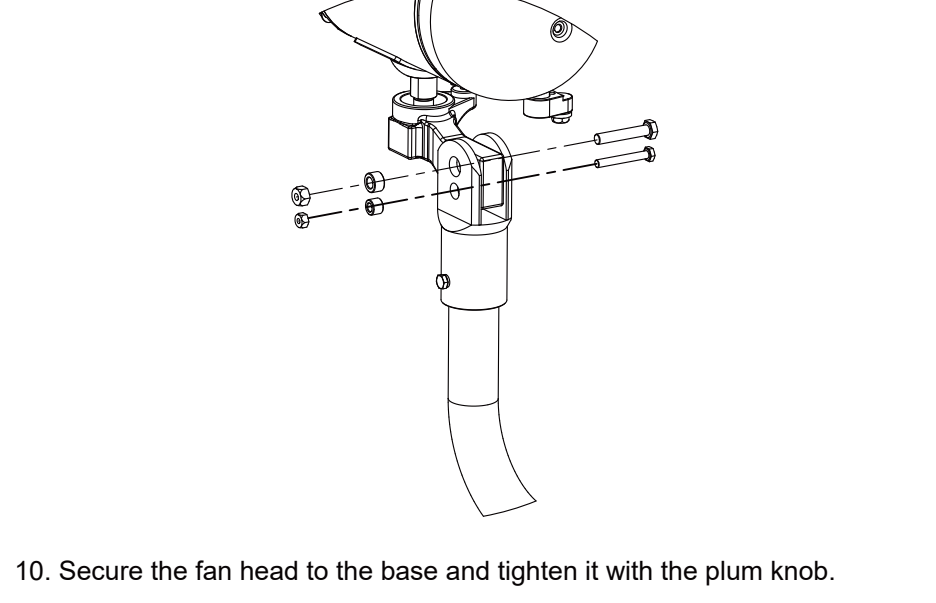

OPERATION INSTRUCTION

1. Use the pull chain switch located on back of motor to operate the fan or select speeds.

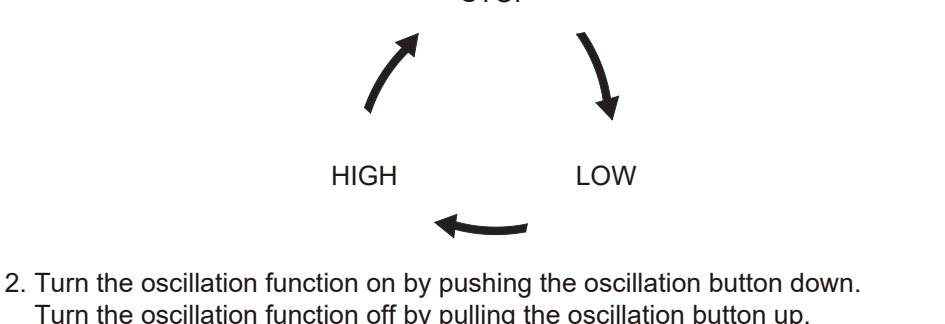

2. Turn the oscillation function on by pushing the oscillation button down. Turn the oscillation function off by pulling the oscillation button up.



3. To adjust the angle of the fan head, loosen the M6 hex nut, tilt the fan head to the desired angle, and re-tighten the M6 hex nut.

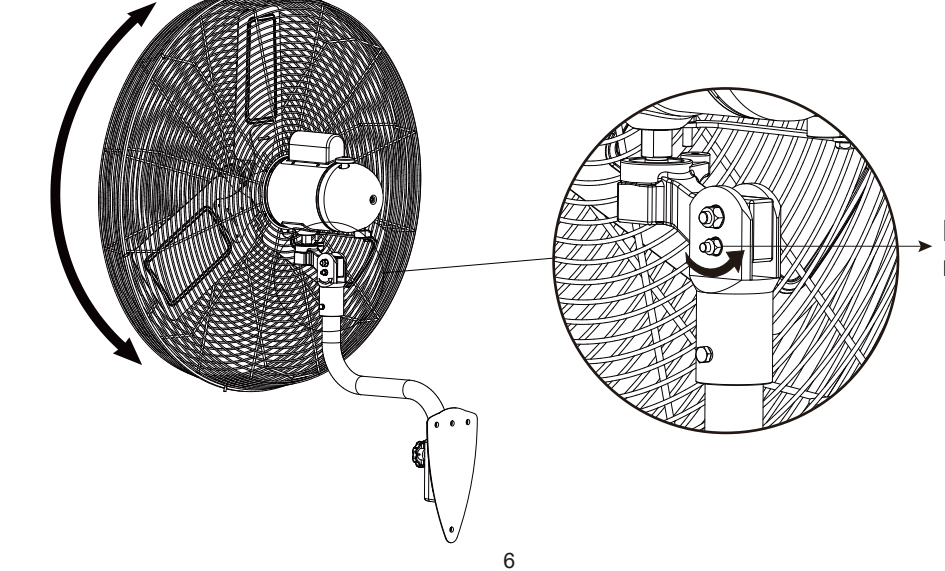

CARE AND CLEANING

Unplug the appliance before cleaning. Don't use any water for cleaning metal surfaces. Slightly moisten a cloth and then wipe off the surfaces of the fan. In order to remove dust from the grill, use a vacuum cleaner or remove the front grill by removing the securing screws on the edge of the grill. After cleaning, remount the grill. After doing this, fasten the screws on the edge of the grill.

1-YEAR LIMITED WARRANTY

The manufacturer warrants this product to be free from manufacturing defects in the material and workmanship under normal use for a period of one year after the date of purchase by the original purchaser. This warranty does not cover transit damages. This warranty does not apply to damages from accident, misuse, alteration of any kind to the fan or where the connected voltage is more than above the nameplate voltage. This warranty does not apply to the finish on any portion of the product. Servicing performed by unauthorized persons shall render the warranty invalid. The warranty is not responsible for damages of any kind, including accident and consequential damages. Some states do not allow the exclusion or limitation of the incidental or consequential damages, so the above exclusion or limitation may not apply to you. This warranty gives you specific legal rights, and you may also have other rights which vary from state to state.

Warning:

Use of secondary safety support cable does not guarantee protection against injury of persons. Mounting of both the circulator and cable must fall if subject to attach negligently or if improperly installed. To avoid personal injury, circulators must be supported anytime angle is adjusted.

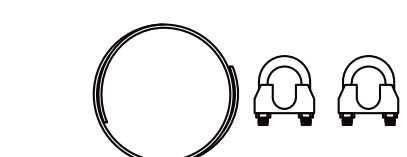

PARTS	SPECIFICATION	QTY
1	φ3*3050	1
2	M5*13	2

1. Loop one end of the cable around the large diameter wires of both the front and rear guard as shown below. Attach a cable retainer with the "U" on the tail side of the loop leaving a tail of approximately 1 to 2 inches. Tighten clamp nuts forming a tight loop, 32in. lbs of torque. Make sure the cable does not interfere with the propeller.

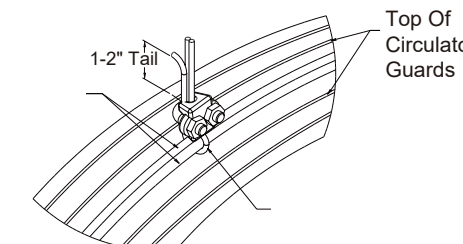

Installation -- Secondary Safety Support Cable

2. Wrap the other end of the cable around a secure building joist, beam, truss or other support near the fan as shown below. Take up all excess slack in the cable. If the fan is an oscillating model and wall mounted, leave enough slack to allow free movement through range of motion.

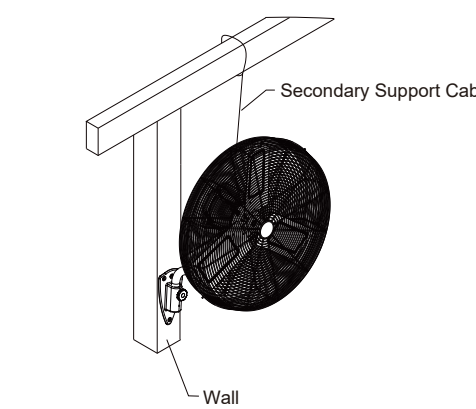

3. Attach the remaining cable retainers as done previously in "step 1". The excess tail should be trimmed to extend 1 to 2 inches past the second clamp.
4. Check the assembly to assure the propeller is free of all obstructions and turns freely.
5. Connect the circulator to the proper power supply ensuring that it conforms to the electrical rating listed on the circulator's motor nameplate.