

# Two-Tier Double-Bent Handle Cart Instruction Manual

## Parts List

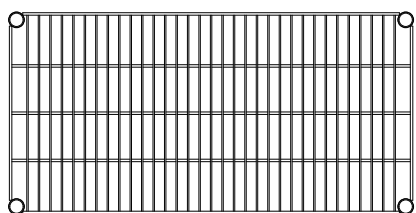

Wire Shelves (2 pieces)

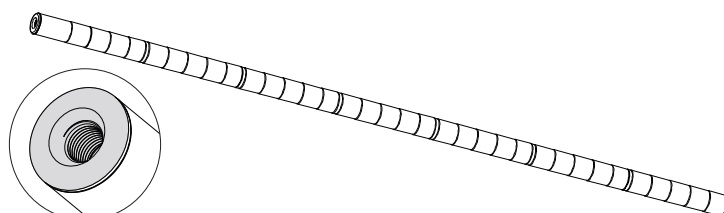

Bottom Tubes (4 pieces)

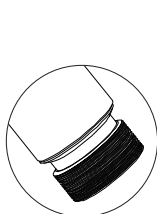

Bent Handles (2 pieces)

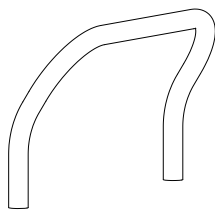

Clips (16 pieces)

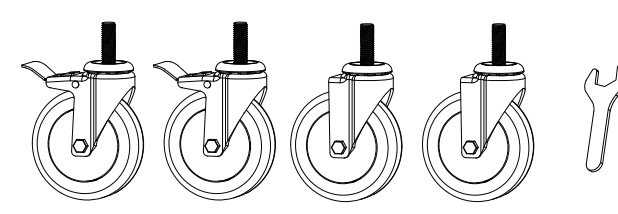

Screw-Threaded Casters (4 pieces)

## Precautions

- Please refer to the table for the quantity of components.
- To avoid accidents, do not sit or stand on this product.
- Do not place items exceeding the load-bearing capacity of this product.
- It is recommended to use neutral cleaning agents or specialized metal cleaners to avoid damaging the metal surface or coating.
- The round black hollow plastic pads are used only for product protection during transportation and are not part of the assembly. After confirming that there are no issues with the installation, dispose of them together with the box.



Maintain cleanliness;  
do not litter

## Troubleshooting

- After assembly, if the product slightly wobbles, use a hammer or a heavy object with a towel as a cushion to tap the edges of the wire shelf along the wavy sides. This ensures a tighter connection between the wedge and the vertical post, making it more stable.
- If the clip does not secure properly, try pushing the clip downward onto the post after aligning it. Listen for a "click" sound, ensuring the clip's slot aligns with the groove on the post to lock it in place.
- The connector can be unscrewed and removed. If the handle does not come with a connector, check whether the bottom tube post has one attached.

# Assembly Steps

Before installation, please place cardboard or similar materials on the floor or surface to prevent scratches or damage to the product or the floor/surface.

- ① Connect the bent handle and bottom tube together using the connector.

※When installing, lay wooden boards or thick cardboard on the ground to avoid damaging the posts.

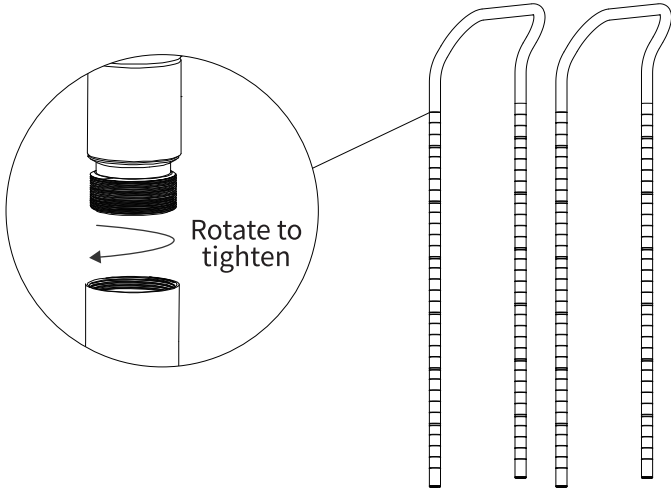

- ② Stand the first wire shelf upright and slide it onto the bent handle posts.

※Do not install the clips yet.

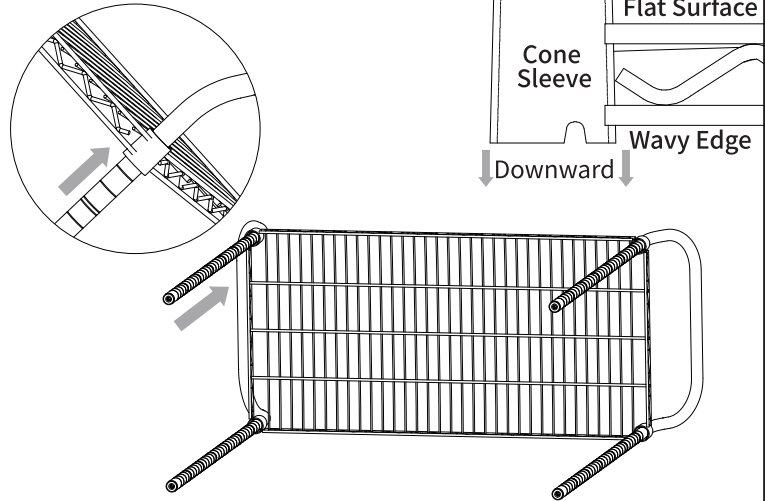

- ③ Clip the fastening clips into the appropriate groove at the desired height and secure the first wire shelf.

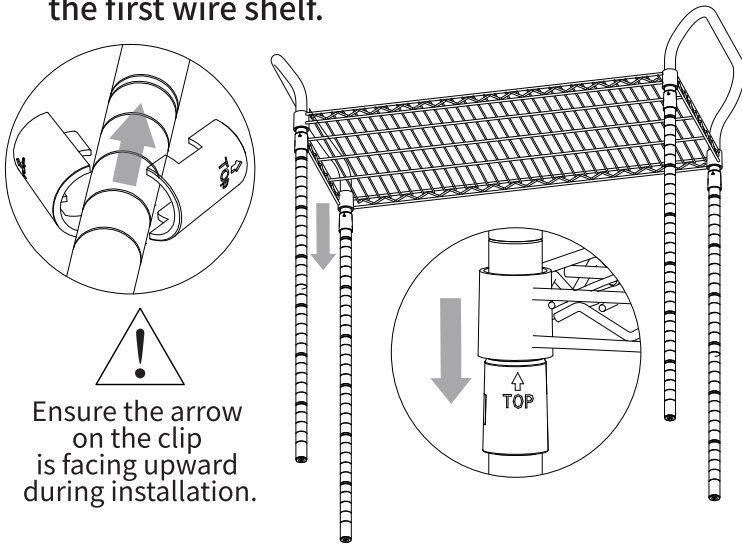

- ④ Repeat the above steps to install and secure all wire shelves.

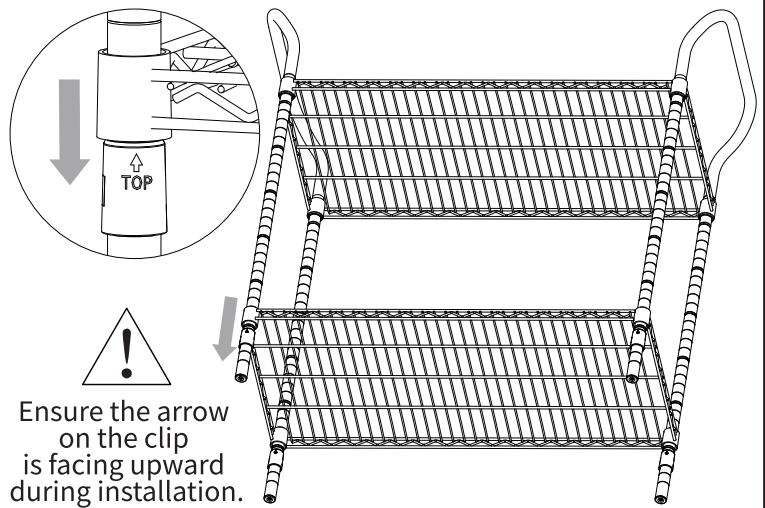

- ⑤ Use a hammer or a heavy object with a towel as a cushion to tap the wavy edges of the wire shelf, ensuring a tighter and more secure connection between the cone sleeve and the vertical posts.

※Lay wooden boards or thick cardboard on the floor before tapping to avoid damaging the product.

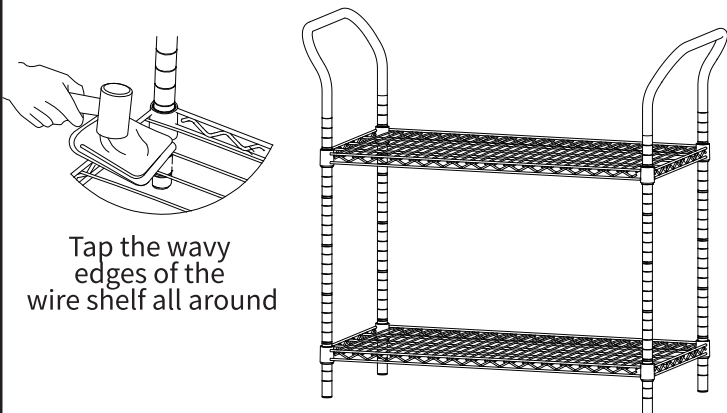

- ⑥ Attach all the wheels to the bottom tubes.

※Install the wheels with brakes on the same side of the bottom tubes; do not install diagonally.

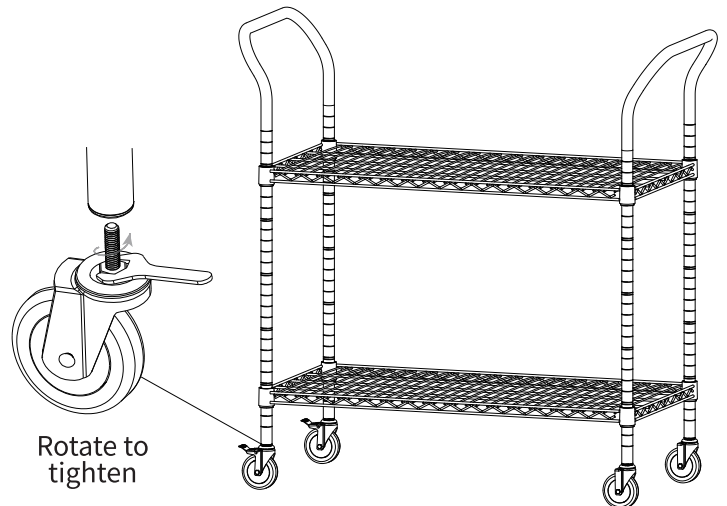

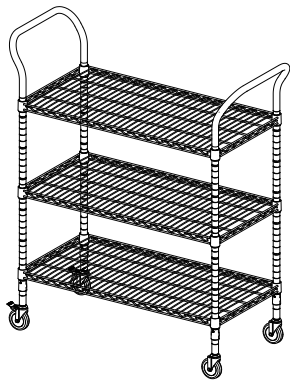

# Three-Tier Double-Bent Handle Cart Instruction Manual

## Parts List

Wire Shelves (3 pieces)	Middle Tubes (4 pieces)	Bottom Tubes (4 pieces)
Bent Handles (2 pieces)	Clips (24 pieces)	Screw-Threaded Casters (4 pieces)

## Precautions

- Please refer to the table for the quantity of components.
- To avoid accidents, do not sit or stand on this product.
- Do not place items exceeding the load-bearing capacity of this product.
- It is recommended to use neutral cleaning agents or specialized metal cleaners to avoid damaging the metal surface or coating.
- The round black hollow plastic pads are used only for product protection during transportation and are not part of the assembly. After confirming that there are no issues with the installation, dispose of them together with the box.



Maintain cleanliness;  
do not litter

## Troubleshooting

- After assembly, if the product slightly wobbles, use a hammer or a heavy object with a towel as a cushion to tap the edges of the wire shelf along the wavy sides. This ensures a tighter connection between the wedge and the vertical post, making it more stable.
- If the clip does not secure properly, try pushing the clip downward onto the post after aligning it. Listen for a "click" sound, ensuring the clip's slot aligns with the groove on the post to lock it in place.
- The connector can be unscrewed and removed. If the handle does not come with a connector, check whether the bottom tube post has one attached.

# Assembly Steps

Before installation, please place cardboard or similar materials on the floor or surface to prevent scratches or damage to the product or the floor/surface.

- ① Connect the bent handle, middle tube and bottom tube together using the connector.

※When installing, lay wooden boards or thick cardboard on the ground to avoid damaging the posts.

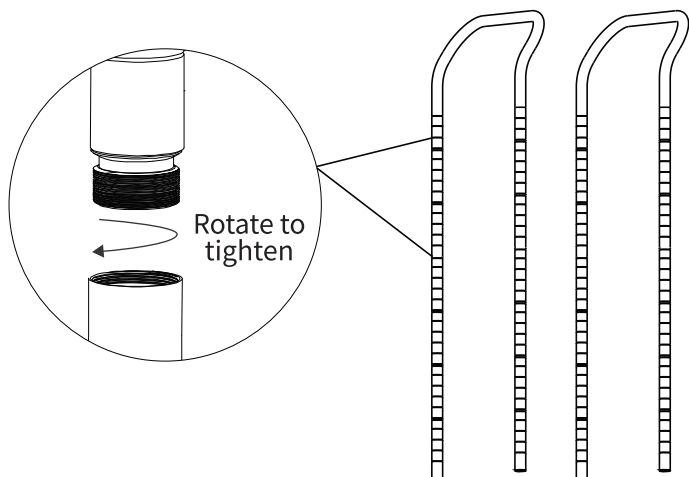

- ② Stand the first wire shelf upright and slide it onto the bent handle posts.

※Do not install the clips yet.

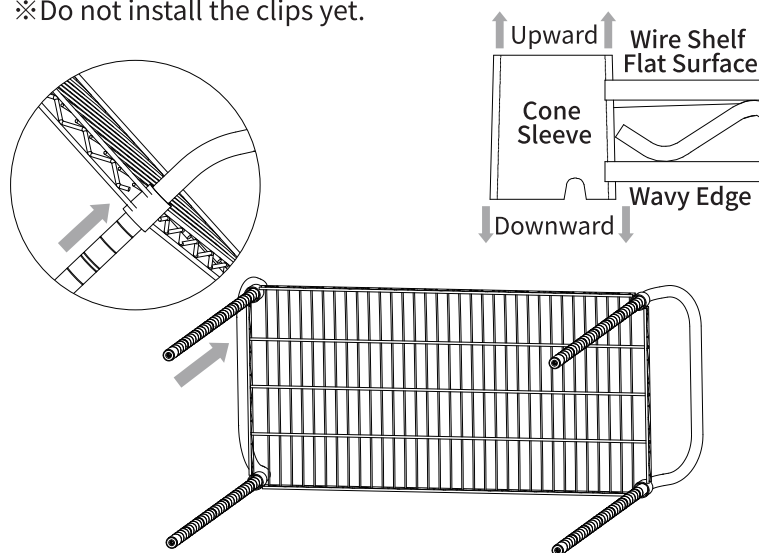

- ③ Clip the fastening clips into the appropriate groove at the desired height and secure the first wire shelf.

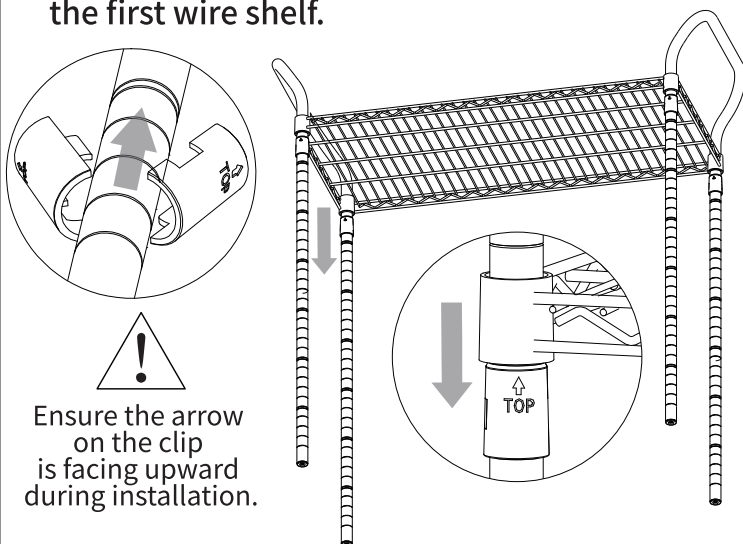

- ④ Repeat the above steps to install and secure all wire shelves.

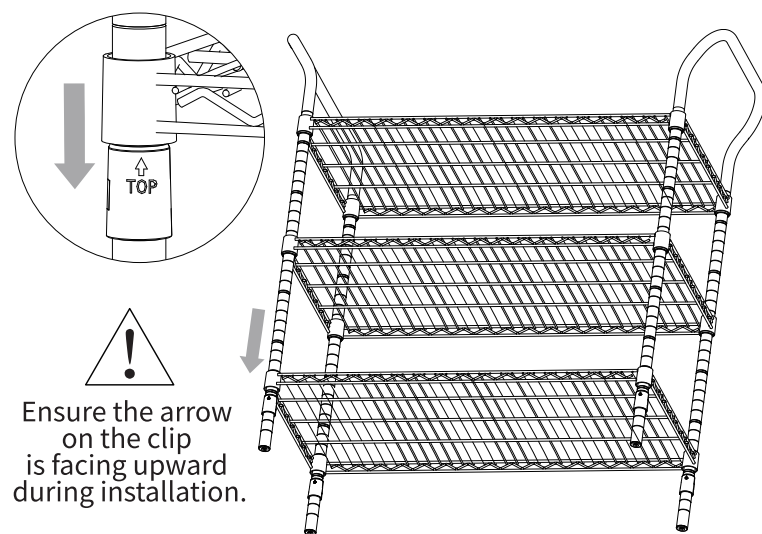

- ⑤ Use a hammer or a heavy object with a towel as a cushion to tap the wavy edges of the wire shelf, ensuring a tighter and more secure connection between the cone sleeve and the vertical posts.

※Lay wooden boards or thick cardboard on the floor before tapping to avoid damaging the product.

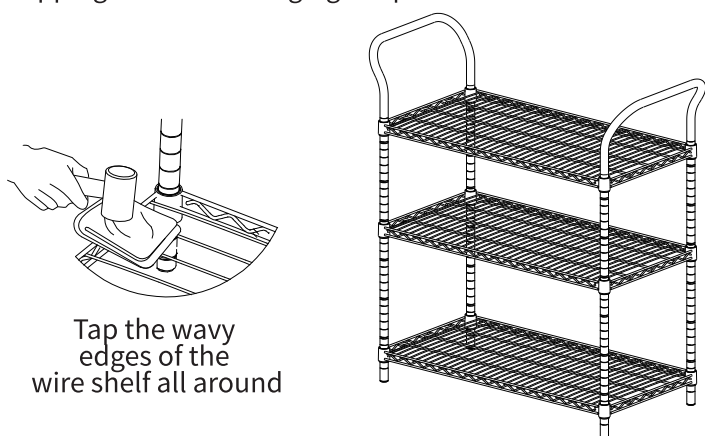

- ⑥ Attach all the wheels to the bottom tubes.

※Install the wheels with brakes on the same side of the bottom tubes; do not install diagonally.

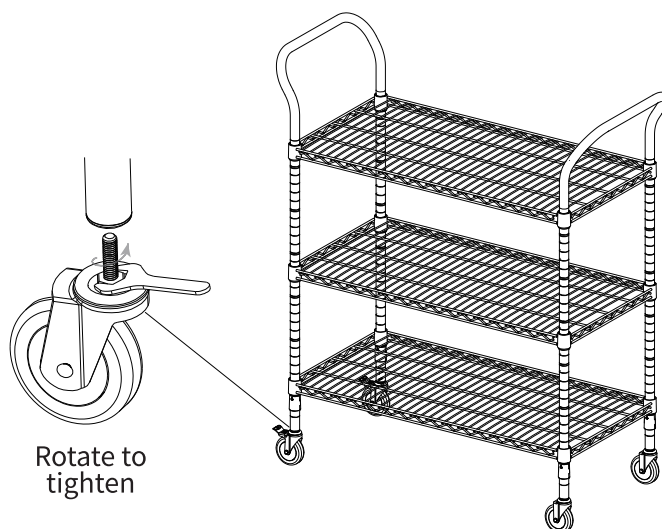



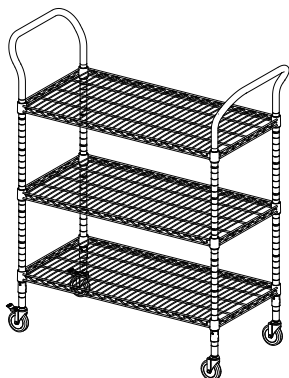

# Three-Tier Double-Bent Handle Cart Instruction Manual

## Parts List

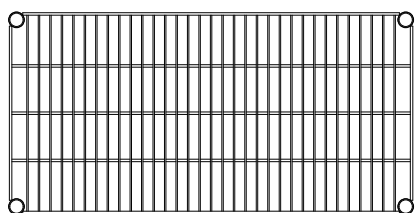

Wire Shelves (2 pieces)

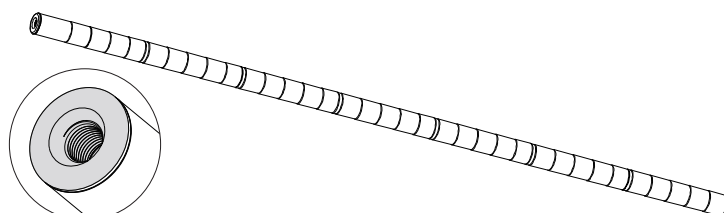

Bottom Tubes (4 pieces)

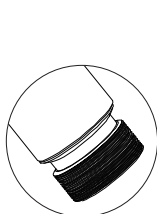

Bent Handles (2 pieces)

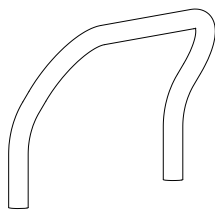

Clips (24 pieces)

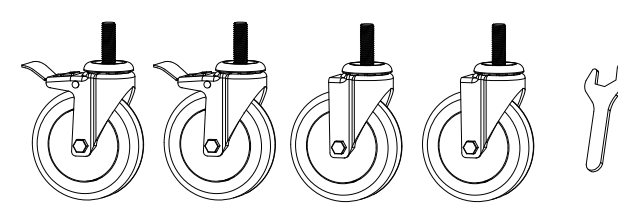

Screw-Threaded Casters (4 pieces)

## Precautions

- Please refer to the table for the quantity of components.
- To avoid accidents, do not sit or stand on this product.
- Do not place items exceeding the load-bearing capacity of this product.
- It is recommended to use neutral cleaning agents or specialized metal cleaners to avoid damaging the metal surface or coating.
- The round black hollow plastic pads are used only for product protection during transportation and are not part of the assembly. After confirming that there are no issues with the installation, dispose of them together with the box.



Maintain cleanliness;  
do not litter

## Troubleshooting

- After assembly, if the product slightly wobbles, use a hammer or a heavy object with a towel as a cushion to tap the edges of the wire shelf along the wavy sides. This ensures a tighter connection between the wedge and the vertical post, making it more stable.
- If the clip does not secure properly, try pushing the clip downward onto the post after aligning it. Listen for a "click" sound, ensuring the clip's slot aligns with the groove on the post to lock it in place.
- The connector can be unscrewed and removed. If the handle does not come with a connector, check whether the bottom tube post has one attached.

# Assembly Steps

Before installation, please place cardboard or similar materials on the floor or surface to prevent scratches or damage to the product or the floor/surface.

- ① Connect the bent handle and bottom tube together using the connector.

※When installing, lay wooden boards or thick cardboard on the ground to avoid damaging the posts.

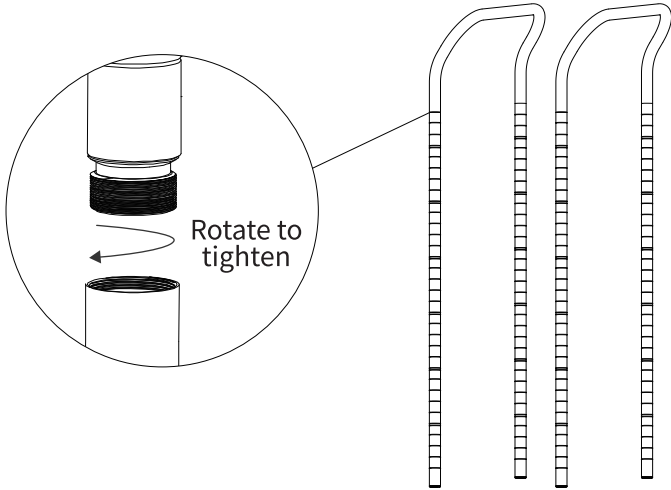

- ② Stand the first wire shelf upright and slide it onto the bent handle posts.

※Do not install the clips yet.

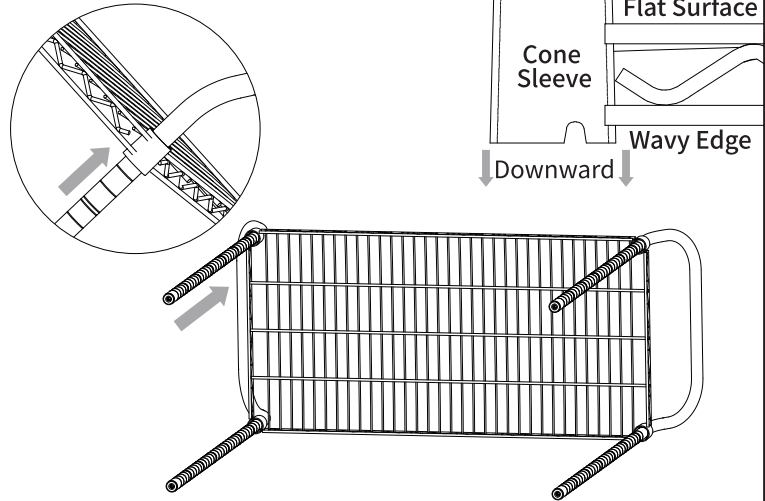

- ③ Clip the fastening clips into the appropriate groove at the desired height and secure the first wire shelf.

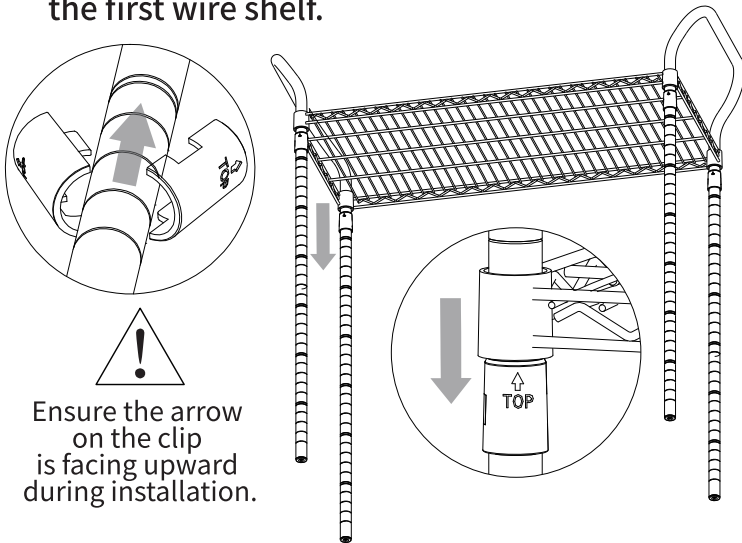

- ④ Repeat the above steps to install and secure all wire shelves.

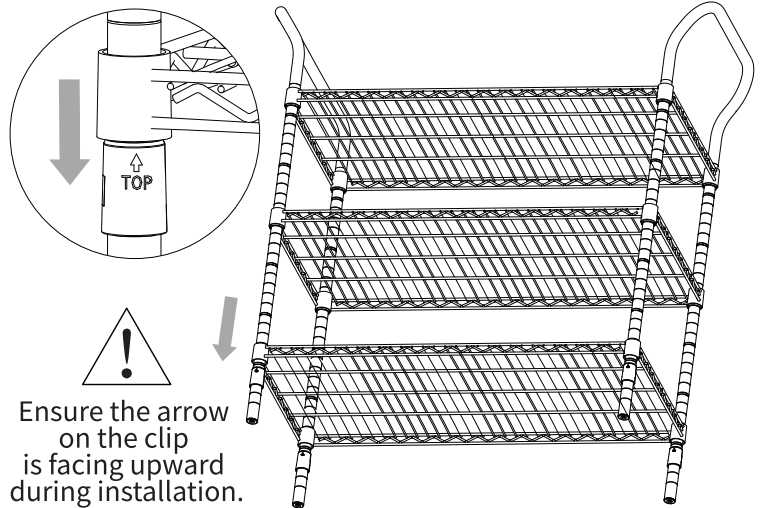

- ⑤ Use a hammer or a heavy object with a towel as a cushion to tap the wavy edges of the wire shelf, ensuring a tighter and more secure connection between the cone sleeve and the vertical posts.

※Lay wooden boards or thick cardboard on the floor before tapping to avoid damaging the product.

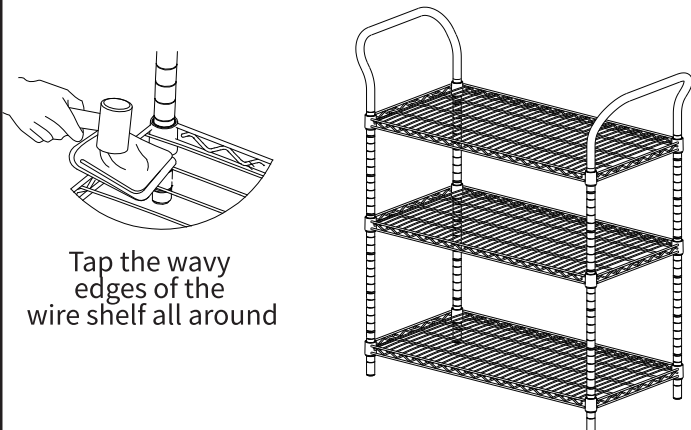

- ⑥ Attach all the wheels to the bottom tubes.

※Install the wheels with brakes on the same side of the bottom tubes; do not install diagonally.

